

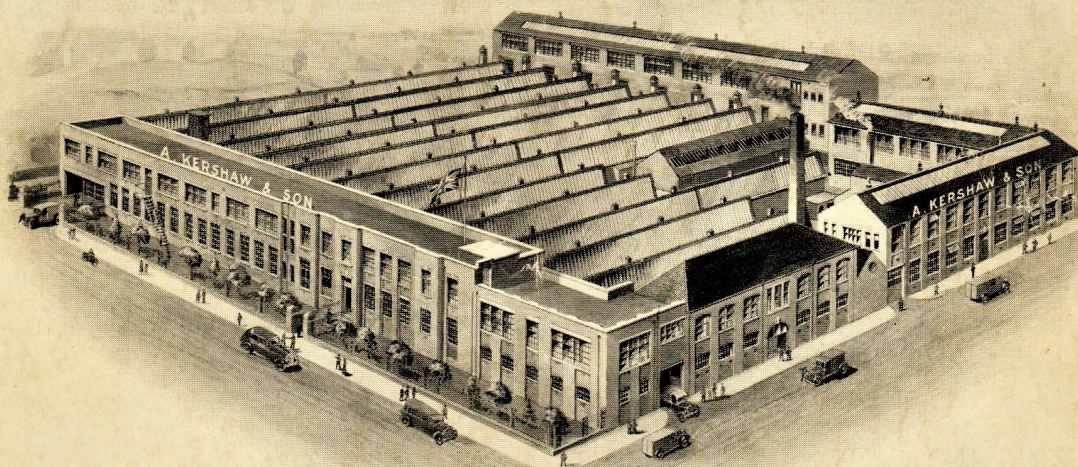

The Home of Kershaw Productions

WHERE THE "KALEE" MODEL TWELVE
CINEMATOGRAF PROJECTORS AND
ACCESSORIES ARE MANUFACTURED

ALL BRITISH CAPITAL • ALL BRITISH LABOUR



SOLE MAKERS:

A. KERSHAW & SON, LEEDS 8 (ENGLAND)

(Branch of Soho Limited)

SOLE DISTRIBUTORS:

KALEE LIMITED

HEAD OFFICE: NATIONAL HOUSE, 60-66 WARDOUR STREET, LONDON, W.1

TELEPHONE: GERRARD 5137-5138-5139.

TELEGRAMS: "ELLANGRICA RATH LONDON."

BRANCHES:

BELFAST: 49 Donegall Street

Telephone 27065

BIRMINGHAM: 16 John Bright Street

Telephone: Midland 3619

CARDIFF: 9 Park Lane

Telephone 7676

DUBLIN: 34 Lower Abbey Street

Telephone 45059

GLASGOW: 211 Hope Street

Telephone: Douglas 1305

LEEDS: 17 Wellington Street

Telephone 28259

MANCHESTER: Parsonage Chambers, 3 The Parsonage

Telephone: Blackfriars 8317

NEWCASTLE: 17 Fenkle Street

Telephone 23038





Terms and Conditions of Sale

NEW ACCOUNTS

2½% for cash ten days after installation, otherwise strictly net thirty days.

HIRE PURCHASE

Terms on request.

ORDERING

Please quote catalogue code words or numbers.

Orders for goods that are not our current standard products are accepted on the implied condition that being manufactured special, they will be charged accordingly and return cannot be accepted.

BREAKAGE OR LOSS IN TRANSIT

All goods are carefully packed and sent F.O.R. Leeds. No claim can be considered by us for damage, breakage, loss or delay in transit.

Goods should be signed for after examination, or signed "unexamined," so that purchaser can institute the necessary claim on the carriers within three days from receipt of goods.

PACKING AND CASES

If returned in good condition, carriage paid, within 14 days, full allowance will be made.

TIME OF DELIVERY

Promises are always based from the date at which all necessary particulars are in our hands, and are subject to the usual strike and accident clauses. In no case, however, will the Company be responsible for consequent loss or damage due to any cause whatever.

DESCRIPTIVE MATTER AND ILLUSTRATIONS

Are typical and must not be held as binding. The Company reserves the right to alter designs and make improvements as the occasion arises.

LIST PRICES

Prices contained herein are subject to revision without notice.





Kalee Model Twelve PROJECTOR

OUTSTANDING FEATURES

GATE: Very rigid construction. Instantaneously detached for cleaning, etc.

FILM Incorporate two important distinguishing features:—

GUIDE
ROLLERS:

- (1) Automatic film tracking.
- (2) Pivoted for free running.

Twin adjustable tension, light steel skates. "Patented" Interlocking Pawl comes into action immediately the gate is opened, withdrawing the roller cradle from the Intermittent Sprocket Teeth and allowing increased film engagement to the Intermittent Sprocket. Each Cradle Roller is adjustable:—

- (1) Upper Roller by means of eccentric spindle.
- (2) Lower Roller by means of knurled nut.

GATE The masking plate, quickly replaced, slides into position without any screws, etc.,
FRAME: and incorporates double aperture:—

- (1) Upper Aperture for masking.
- (2) Lower Aperture for projection.

A Masking Lamp is embodied, controlled by tumbler switch.
Enclosed Drum Shutter with combined Automatic Cut-off.

DRUM Gives perfect balance of cut-off and light projection—producing a flickerless picture
SHUTTER: on the screen. Internal centrifugal positive automatic shutter.

MASKING: Control handle located in most convenient position, is non-reversible giving positive picture mask without slip. Compensation of Drum Shutter when masking is obtained by a link and sliding gear action of very substantial construction, and covered by patents.

MAIN

CASTING: An accurately machined box form casting of heavy construction.

LUBRICA- Automatic, provided by a circular positive gear type pump. Oil is filtered before
TION: entering the pump, passed through a novel filter box and delivered to the components by means of suitable pipes. A novel transparent unbreakable cap is located at the top of the main frame and serves as a clearly visible indicator of oil circulation. The window with indicating lines shows the quantity of oil required when the mechanism is stationary.

BEARINGS They are designed to furnish correct lubrication and provided with specially
and designed "throw-backs" so that the oil is returned to the oil well. Spindles are
SPINDLES: of tough high carbon steel, ground to extremely fine limits.

FOCUS- Micrometer focussing, critical and rigid due to complete elimination of "backlash,"
SING: and when set can be rigidly locked.

GEARING: The Gear Train is designed for everlasting wear, but is extremely free running.

ADAPTER The construction of the whole projector makes use of very simple adapter gears,
GEARS: so that it is readily connected to any make of Sound System.





Kalee Model Twelve PROJECTOR

OUTSTANDING FEATURES

GUIDE

ROLLERS: Incorporate miniature ball-bearings which give great freedom and long life.

INTER-MITTENT UNIT:

This all-important component is constructed in the form of a complete Unit which can be quickly removed or replaced. A supplementary dished cover is located on the main body cover and is readily removed by means of four screws which engage it with the main cover. When this cover is removed, the intermittent unit is exposed and only requires the removal of two nuts to withdraw the Unit.

MALTESE CROSS:

This is the most vital part of the Projection Mechanism and may correctly be termed the "Heart" of the Projector. The material from which it is made is a special high tensile alloy steel, heat treated. The highest skill is employed in its manufacture, in conjunction with most accurate precision machinery, finished by grinding to extremely fine limits of accuracy. The Cross is of large size, ensuring long life.

OIL DRAIN:

A drain plug is provided for running off the oil, and at the top of the mechanism a filler plug is fitted.

Every minute detail of the Kalee Model Twelve Projector Mechanism has received the closest thought in design, selection of material, workmanship and finish, so as to produce in the completed machine the last word in Projector Construction.

SOLE MAKERS:

A. KERSHAW & SON, LEEDS 8 (ENGLAND)

(Branch of Soho Limited)

SOLE DISTRIBUTORS:

KALEE LIMITED

HEAD OFFICE: NATIONAL HOUSE, 60-66 WARDOUR STREET, LONDON, W.1

TELEPHONE: GERRARD 5137-5138-5139.

TELEGRAMS: "ELLANGRICA RATH LONDON."

BRANCHES:

BELFAST: 49 Donegall Street	Telephone 27065
BIRMINGHAM: 16 John Bright Street	Telephone: Midland 3619
CARDIFF: 9 Park Lane	Telephone 7676
DUBLIN: 34 Lower Abbey Street	Telephone 45059
GLASGOW: 211 Hope Street	Telephone: Douglas 1305
LEEDS: 17 Wellington Street	Telephone 28259
MANCHESTER: Parsonage Chambers, 3 The Parsonage	Telephone: Blackfriars 8317
NEWCASTLE: 17 Fenkle Street	Telephone 23038





Kalee Model Twelve *PROJECTOR*

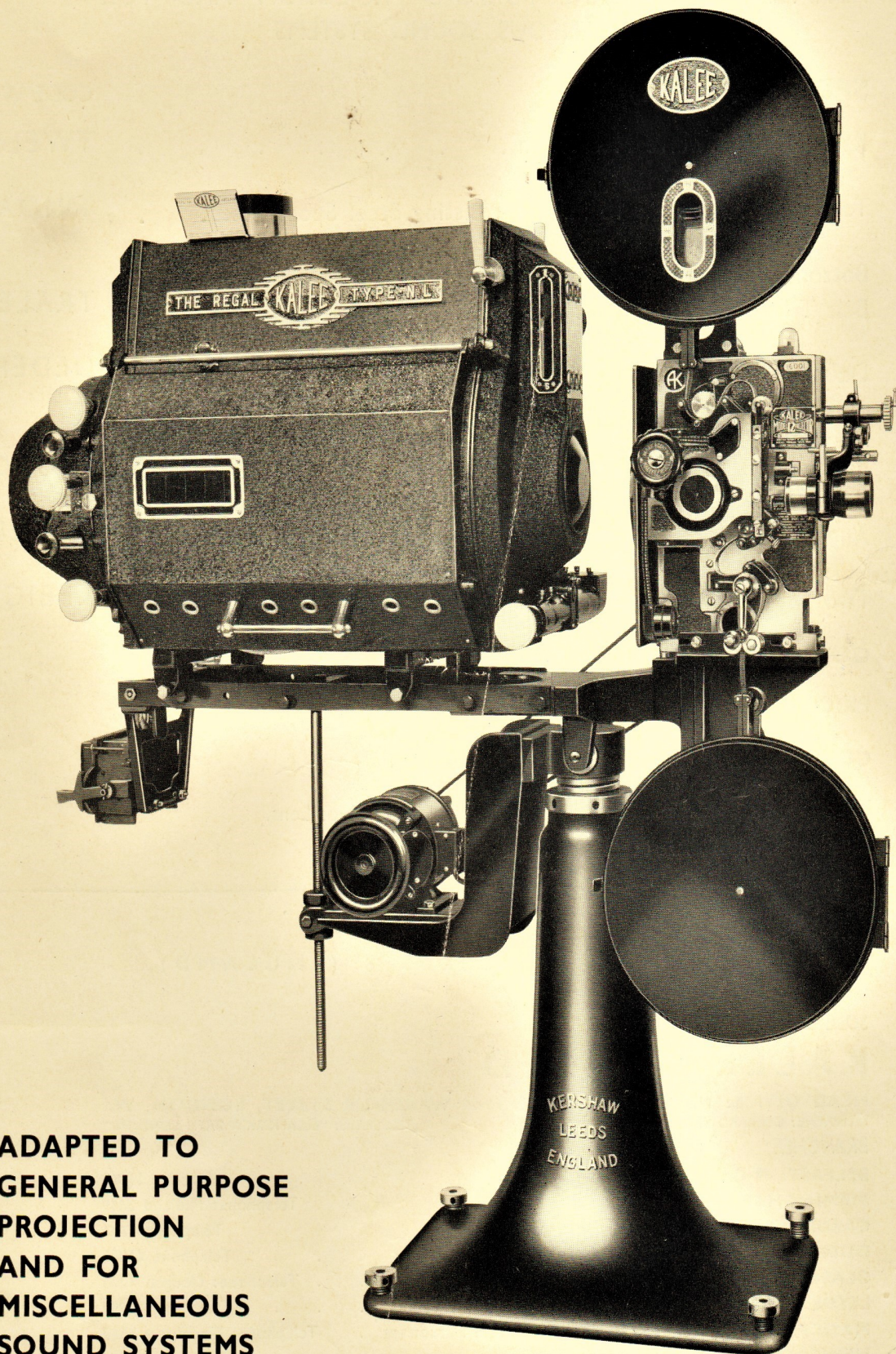

**ADAPTED TO
GENERAL PURPOSE
PROJECTION
AND FOR
MISCELLANEOUS
SOUND SYSTEMS**





Kalee Model Twelve *PROJECTOR*

ADAPTED TO GENERAL PURPOSE PROJECTION AND FOR
MISCELLANEOUS SOUND SYSTEMS

SPECIFICATION

CODE WORD

Kalee Model Twelve Mechanism	TWELL
Top Spool Arm with 16 in. Fire-resisting Steel Spool Box . .	TRIOA
Bottom Spool Arm with 16 in. Fire-resisting Steel Spool Box, Belt Take-up	TRALE
Double Drive Pulley	DEDEP
Adjustable Pedestal Stand with Lamp House Rails and Switch Bracket	STUCO
Angle Bracket to carry Mechanism and Bottom Spool Box . .	STWEL
Two 14 $\frac{3}{4}$ in. Steel Film Spools (Metal Centres)	KEBIC

OUTFIT AS ABOVE:

PRICE: **£154 10 0**

CODE WORD: **SAKID**

The above price does not include Arc Lamp, Leads, Switch or Lens.

All types of KALEE Arc Lamps and Lenses can be fitted.

SOLE MAKERS:

A. KERSHAW & SON, LEEDS 8 (ENGLAND)

(Branch of Soho Limited)

SOLE DISTRIBUTORS:

KALEE LIMITED

HEAD OFFICE: NATIONAL HOUSE, 60-66 WARDOUR STREET, LONDON, W.1

TELEPHONE: GERRARD 5137-5138-5139.

TELEGRAMS: "ELLANGRICA RATH LONDON."

BRANCHES:

BELFAST: 49 Donegall Street	Telephone 27065
BIRMINGHAM: 16 John Bright Street	Telephone: Midland 3619
CARDIFF: 9 Park Lane	Telephone 7676
DUBLIN: 34 Lower Abbey Street	Telephone 45059
GLASGOW: 211 Hope Street	Telephone: Douglas 1305
LEEDS: 17 Wellington Street	Telephone 28259
MANCHESTER: Parsonage Chambers, 3 The Parsonage . .	Telephone: Blackfriars 8317
NEWCASTLE: 17 Fenkle Street	Telephone 23038





Kalee Model Twelve PROJECTOR

MECHANISM

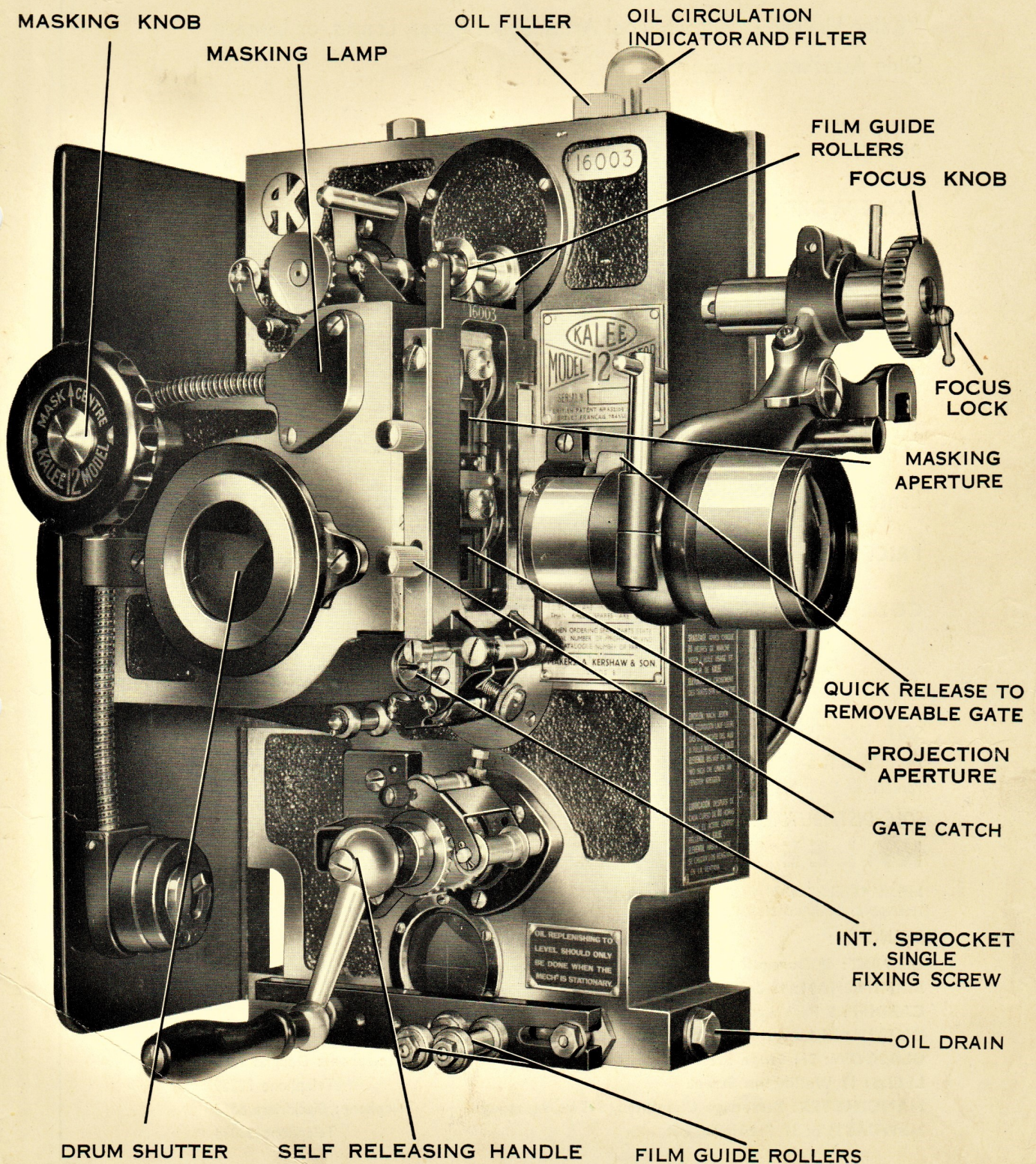



Kalee Model Twelve PROJECTOR MECHANISM

Kalee Model Twelve Projector Mechanism, Spanners, and one Tin of "Kalee Elevenoil" *without* Spool Arms, Spool Boxes, Lenses, or Lantern Slide Attachment Fittings.

PRICE: £115 0 0

CODE WORD: TWELL

16 in. Fire-resisting Top Spool Box and Spool Arm.

PRICE: £5 0 0

CODE WORD: TRIOA

Lantern Slide Attachment Fittings, to fix on Top Spool Box Arm, complete.

PRICE: £3 4 6

CODE WORD: LATWE

SOLE MAKERS:

A. KERSHAW & SON, LEEDS 8 (ENGLAND)

(Branch of Soho Limited)

SOLE DISTRIBUTORS:

KALEE LIMITED

HEAD OFFICE: NATIONAL HOUSE, 60-66 WARDOUR STREET, LONDON, W.1

TELEPHONE: GERRARD 5137-5138-5139.

TELEGRAMS: "ELLANGRICA RATH LONDON."

BRANCHES:

BELFAST: 49 Donegall Street	Telephone 27065
BIRMINGHAM: 16 John Bright Street	Telephone: Midland 3619
CARDIFF: 9 Park Lane	Telephone 7676
DUBLIN: 34 Lower Abbey Street	Telephone 45059
GLASGOW: 211 Hope Street	Telephone: Douglas 1305
LEEDS: 17 Wellington Street	Telephone 28259
MANCHESTER: Parsonage Chambers, 3 The Parsonage	Telephone: Blackfriars 8317
NEWCASTLE: 17 Fenkle Street	Telephone 23038



Kalee Model Twelve *PROJECTOR*

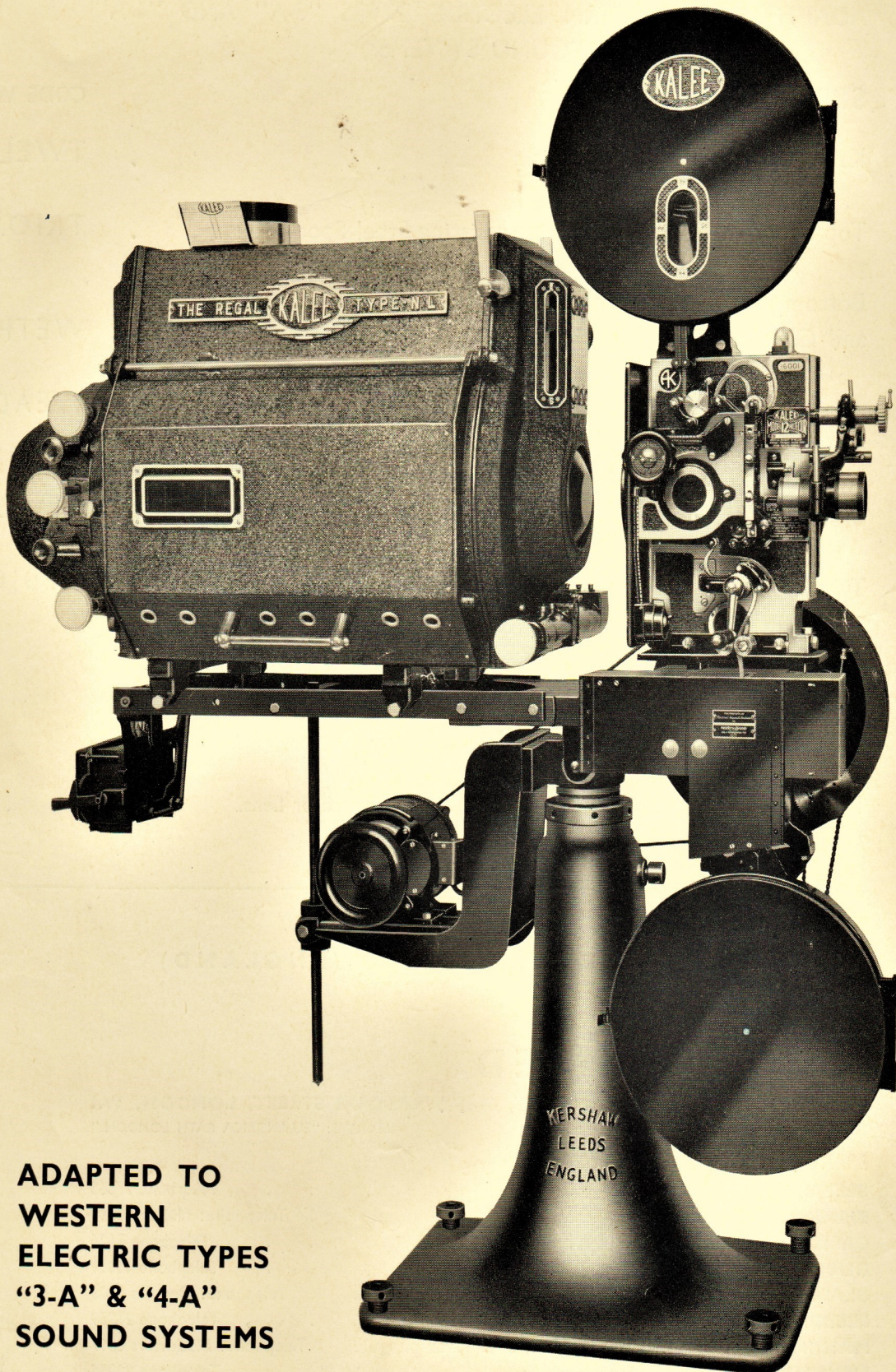

**ADAPTED TO
WESTERN
ELECTRIC TYPES
"3-A" & "4-A"
SOUND SYSTEMS**





Kalee Model Twelve PROJECTOR

ADAPTED TO WESTERN ELECTRIC TYPES "3-A" AND "4-A"
SOUND SYSTEMS

SPECIFICATION

CODE WORD

Kalee Model Twelve Mechanism	TWELL
Top Spool Arm with 16 in. Fire-resisting Steel Spool Box . . .	TRIOA
Bottom Spool Arm with 16 in. Fire-resisting Steel Spool Box and Coupling Gear	WETHA
Adapter Gear and Base Plate for Mechanism	WEADY
Adjustable Pedestal Stand with Lamp House Rails and Switch Bracket	WAPSA
Two 14 $\frac{3}{4}$ in. Steel Film Spools (Metal Centres)	KEBIC

OUTFIT AS ABOVE:

PRICE: £164 0 0

CODE WORD: WRAPA

The above price does not include Arc Lamp, Leads, Switch or Lens.
All types of KALEE Arc Lamps and Lenses can be fitted.

SOLE MAKERS:

A. KERSHAW & SON, LEEDS 8 (ENGLAND)

(Branch of Soho Limited)

SOLE DISTRIBUTORS:

KALEE LIMITED

HEAD OFFICE: NATIONAL HOUSE, 60-66 WARDOUR STREET, LONDON, W.1

TELEPHONE: GERRARD 5137-5138-5139.

TELEGRAMS: "ELLANGRICA RATH LONDON."

BRANCHES:

BELFAST: 49 Donegall Street	Telephone 27065
BIRMINGHAM: 16 John Bright Street	Telephone: Midland 3619
CARDIFF: 9 Park Lane	Telephone 7676
DUBLIN: 34 Lower Abbey Street	Telephone 45059
GLASGOW: 211 Hope Street	Telephone: Douglas 1305
LEEDS: 17 Wellington Street	Telephone 28259
MANCHESTER: Parsonage Chambers, 3 The Parsonage	Telephone: Blackfriars 8317
NEWCASTLE: 17 Fenkle Street	Telephone 23038





Kalee Model Twelve PROJECTOR

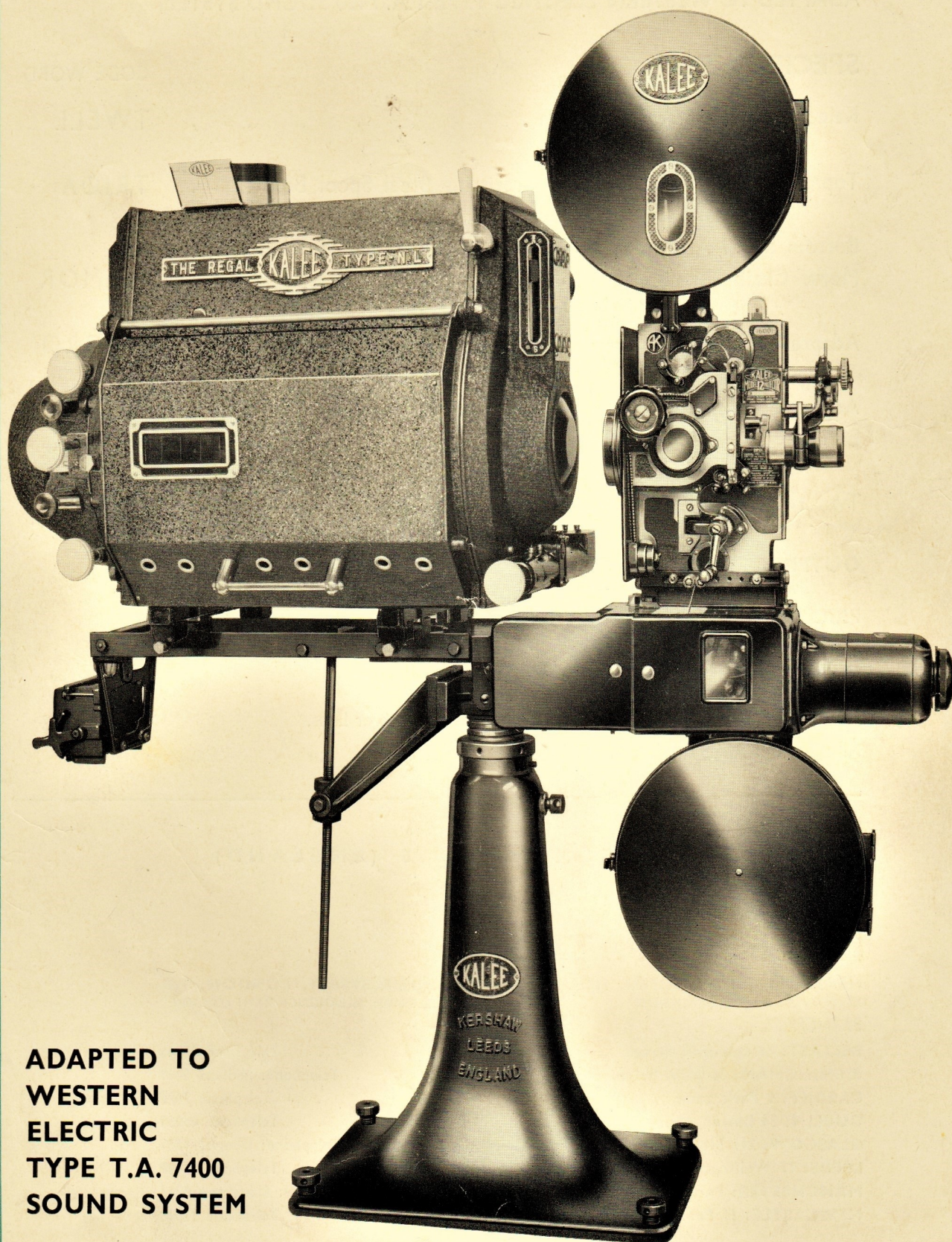

**ADAPTED TO
WESTERN
ELECTRIC
TYPE T.A. 7400
SOUND SYSTEM**





Kalee Model Twelve *PROJECTOR*

ADAPTED TO WESTERN ELECTRIC TYPE T.A. 7400 SOUND SYSTEM

SPECIFICATION

CODE WORD

Kalee Model Twelve Mechanism TWELL

Top Spool Arm with 16 in. Fire-resisting Steel Spool Box TRIOA

Bottom Spool Arm with 16 in. Fire-resisting Steel Spool Box and
Morse Chain Take-up WEMOR

Adapter Gears, Gear Cover, and Base Plate for Mechanism WEGRO

Adjustable Pedestal Stand with Lamp House Rails and Switch
Bracket SWAPA

Two 14 $\frac{3}{4}$ in. Steel Film Spools (Metal Centres) KEBIC

OUTFIT AS ABOVE:

PRICE: £167 0 0

CODE WORD: WESEY

The above price does not include Arc Lamp, Leads, Switch or Lens.

All types of KALEE Arc Lamps and Lenses can be fitted.

SOLE MAKERS:

A. KERSHAW & SON, LEEDS 8 (ENGLAND)

(Branch of Soho Limited)

SOLE DISTRIBUTORS:

KALEE LIMITED

HEAD OFFICE: NATIONAL HOUSE, 60-66 WARDOUR STREET, LONDON, W.1

TELEPHONE: GERRARD 5137-5138-5139

TELEGRAMS: "ELLANGRICA RATH LONDON."

BRANCHES:

BELFAST: 49 Donegall Street Telephone 27065

BIRMINGHAM: 16 John Bright Street Telephone: Midland 3619

CARDIFF: 9 Park Lane Telephone 7676

DUBLIN: 34 Lower Abbey Street Telephone 45059

GLASGOW: 211 Hope Street Telephone: Douglas 1305

LEEDS: 17 Wellington Street Telephone 28259

MANCHESTER: Parsonage Chambers, 3 The Parsonage Telephone: Blackfriars 8317

NEWCASTLE: 17 Fenkle Street Telephone 23038





Kalee Model Twelve PROJECTOR

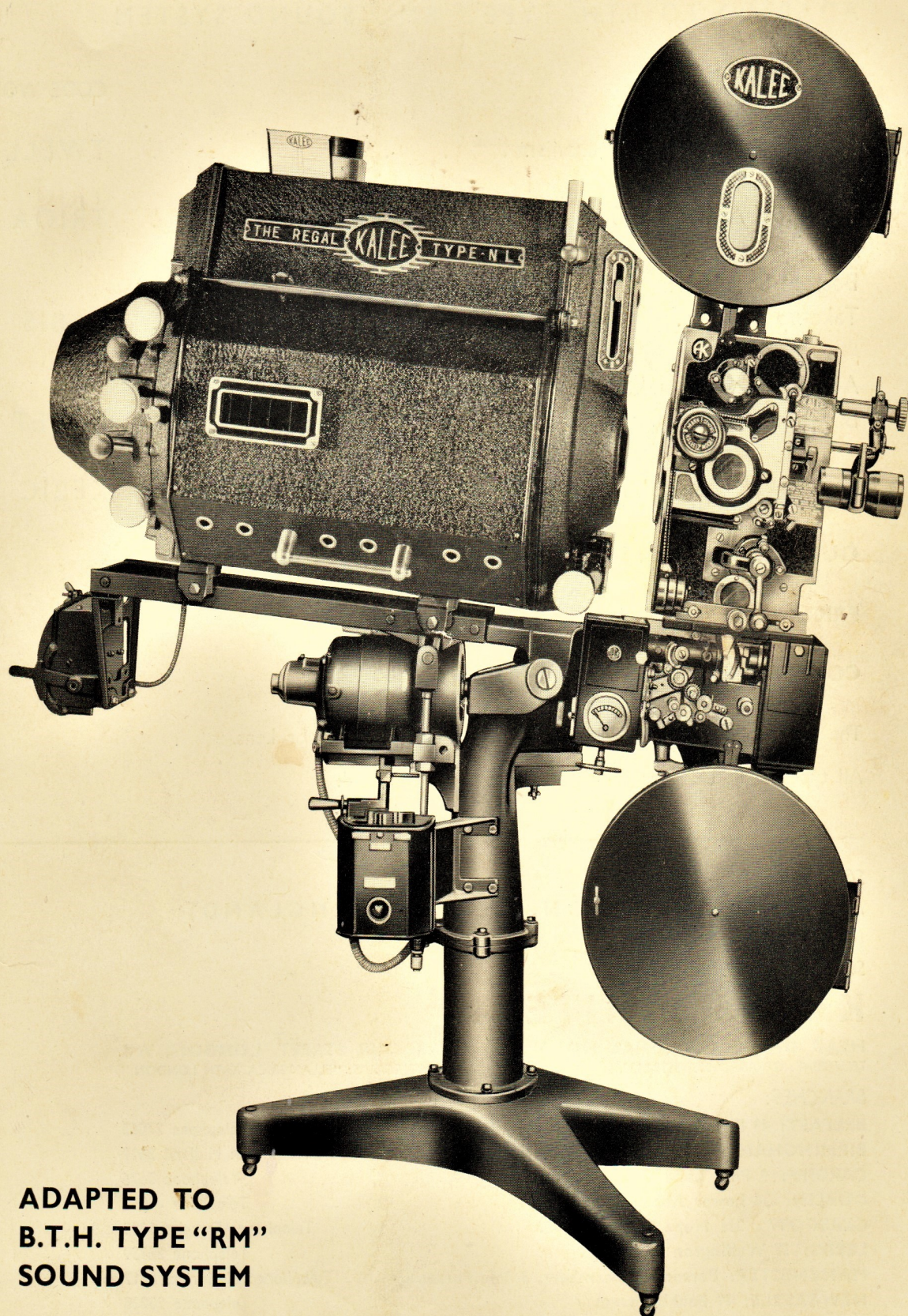

ADAPTED TO
B.T.H. TYPE "RM"
SOUND SYSTEM





Kalee Model Twelve *PROJECTOR*

ADAPTED TO B.T.H. TYPE "RM" SOUND SYSTEM

SPECIFICATION

CODE WORD

Kalee Model Twelve Mechanism	TWELL
Top Spool Arm with 16 in. Fire-resisting Steel Spool Box	TRIOA
Bottom Spool Arm with 16 in. Fire-resisting Steel Spool Box, Belt Take-up	BABIS
Adapter Gears, Bracket and Roller Chain, Gear Cover and Adapter Base Plate	BABET
Two 14 $\frac{3}{4}$ in. Steel Film Spools (Metal Centres)	KEBIC

OUTFIT AS ABOVE:

PRICE: £143 0 0

CODE WORD: BURMA

The above price does not include Arc Lamp, Leads, Switch or Lens.

All types of KALEE Arc Lamps and Lenses can be fitted.

SOLE MAKERS:

A. KERSHAW & SON, LEEDS 8 (ENGLAND)

(Branch of Soho Limited)

SOLE DISTRIBUTORS:

KALEE LIMITED

HEAD OFFICE: NATIONAL HOUSE, 60-66 WARDOUR STREET, LONDON, W.1

TELEPHONE: GERRARD 5137-5138-5139.

TELEGRAMS: "ELLANGRICA RATH LONDON."

BRANCHES:

BELFAST: 49 Donegall Street	Telephone 27065
BIRMINGHAM: 16 John Bright Street	Telephone: Midland 3619
CARDIFF: 9 Park Lane	Telephone 7676
DUBLIN: 34 Lower Abbey Street	Telephone 45059
GLASGOW: 211 Hope Street	Telephone: Douglas 1305
LEEDS: 17 Wellington Street	Telephone 28259
MANCHESTER: Parsonage Chambers, 3 The Parsonage	Telephone: Blackfriars 8317
NEWCASTLE: 17 Fenkle Street	Telephone 23038





KALEE



Kalee Model Twelve PROJECTOR

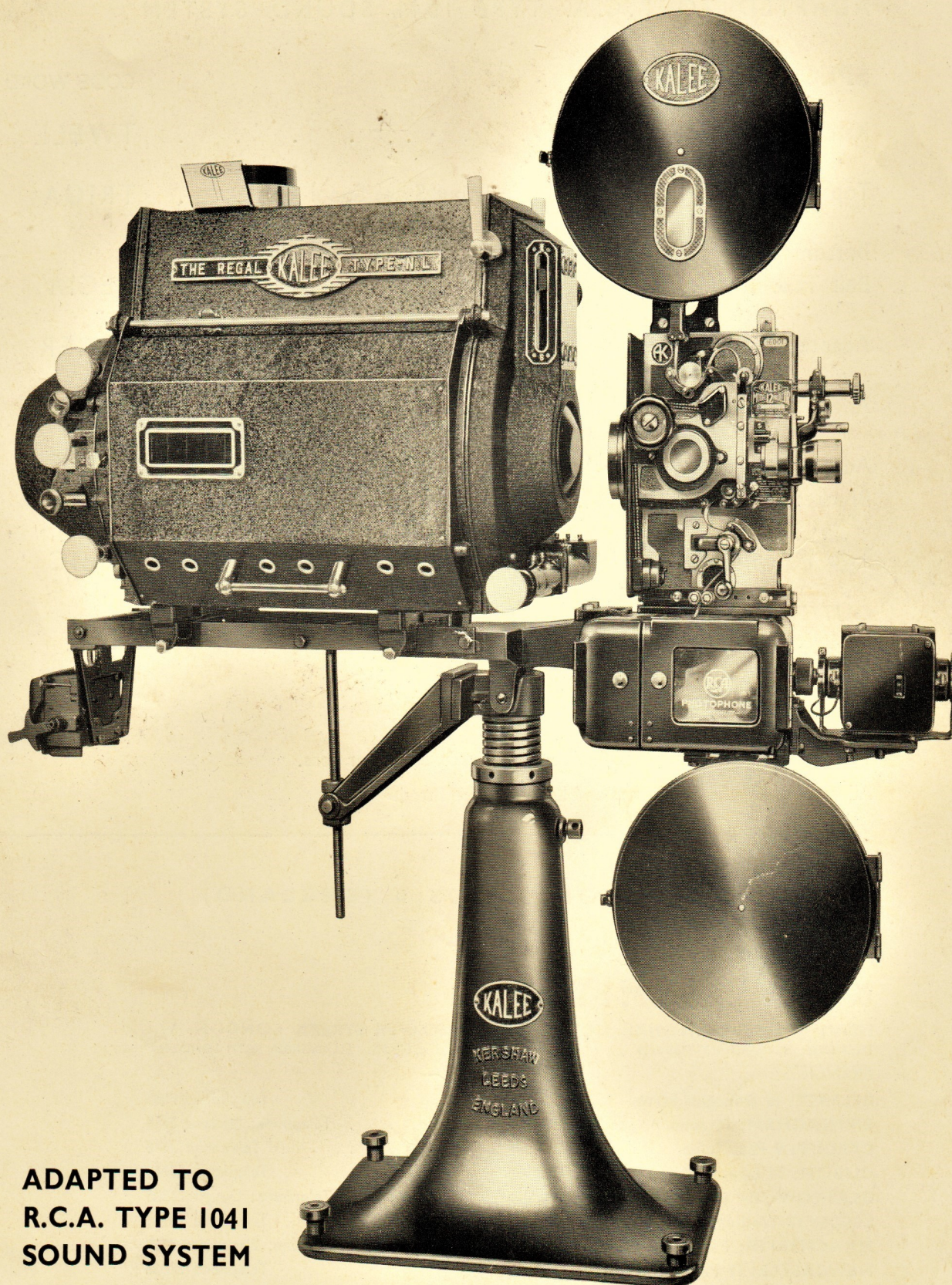

ADAPTED TO
R.C.A. TYPE 1041
SOUND SYSTEM





Kalee Model Twelve *PROJECTOR*

ADAPTED TO R.C.A. TYPE 1041 SOUND SYSTEM

SPECIFICATION

CODE WORD

Kalee Model Twelve Mechanism	TWELL
Top Spool Arm with 16 in. Fire-resisting Steel Spool Box . .	TRIOA
Bottom Spool Arm with 16 in. Fire-resisting Steel Spool Box, Belt Take-up	RECIA
Adapter Gears, Gear Cover, and Base Plate for Mechanism .	REGER
Angle Bracket for Sound Head	RATTA
Adjustable Pedestal Stand with Lamp House Rails and Switch Bracket	RAPAS
Two 14 $\frac{3}{4}$ in. Steel Film Spools (Metal Centres)	KEBIC

OUTFIT AS ABOVE:

PRICE: £161 0 0

CODE WORD: RATEN

The above price does not include Arc Lamp, Leads, Switch or Lens.

All types of KALEE Arc Lamps and Lenses can be fitted.

SOLE MAKERS:

A. KERSHAW & SON, LEEDS 8 (ENGLAND)

(Branch of Soho Limited)

SOLE DISTRIBUTORS:

KALEE LIMITED

HEAD OFFICE: NATIONAL HOUSE, 60-66 WARDOUR STREET, LONDON, W.1

TELEPHONE: GERRARD 5137-5138-5139.

TELEGRAMS: "ELLANGRICA RATH LONDON."

BRANCHES:

BELFAST: 49 Donegall Street	Telephone 27065
BIRMINGHAM: 16 John Bright Street	Telephone: Midland 3619
CARDIFF: 9 Park Lane	Telephone 7676
DUBLIN: 34 Lower Abbey Street	Telephone 45059
GLASGOW: 211 Hope Street	Telephone: Douglas 1305
LEEDS: 17 Wellington Street	Telephone 28259
MANCHESTER: Parsonage Chambers, 3 The Parsonage	Telephone: Blackfriars 8317
NEWCASTLE: 17 Fenkle Street	Telephone 23038





KALEE



“REGAL”

**HIGH INTENSITY REFLECTOR
ARC LAMP TYPE N.L.**

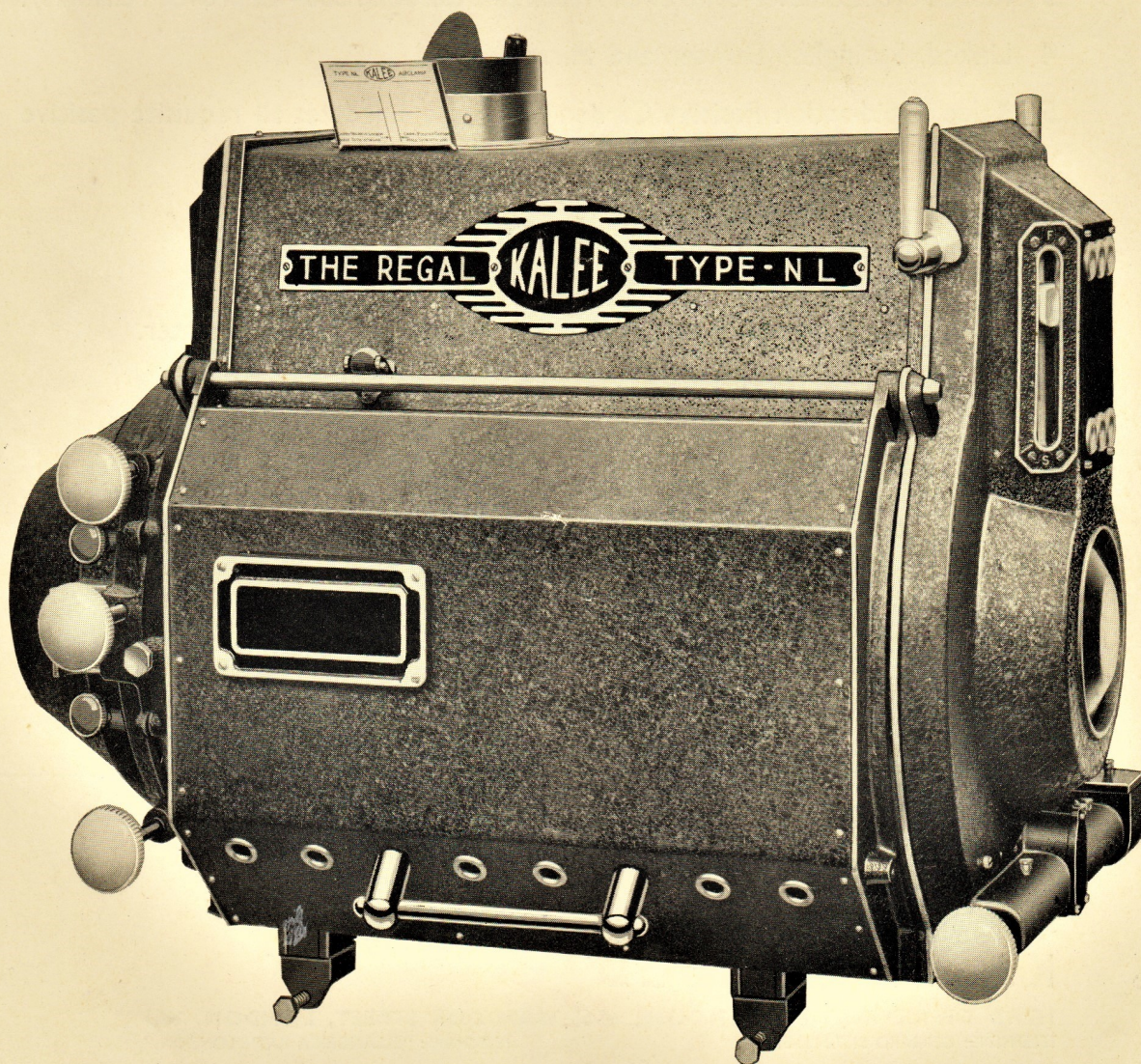

KALEE MEANS SERVICE

Illustrations are not binding; improvements are made as occasion arises
Prices are subject to revision without notice.





KALEE "REGAL" ARC LAMP

embodies the following distinguishing features:—

- 1 Wide-angle Light Collection—obtained by 14-in. diameter, short-focus elliptical mirror.
- 2 Energised Magnetic Flame Control—will not lose efficiency under operating conditions.
- 3 Kalee Potentiometer-controlled Automatic Carbon Feed—of proved reliability.
- 4 Linked, Springless Dowser and Mirror Guard.
- 5 Kalee Rapid-action Positive Carbon Grip accommodates all requisite positive carbons.
- 6 Location of all essential controls on operating side.
- 7 Instantaneous Clutch Release for positive carbon "trimming."
- 8 Periscope and Screen, providing instantly visible image of arc crater.
- 9 Carbon Guides—ensure stability of arc relative to mirror.

PRICE: £97 10 0

CODE WORD: REGAL

SOLE MAKERS:

A. KERSHAW & SON, LEEDS 8 (ENGLAND)

(Branch of Soho Limited)

SOLE DISTRIBUTORS:

KALEE LIMITED

HEAD OFFICE: NATIONAL HOUSE, 60-66 WARDOUR STREET, LONDON, W.1

TELEPHONE: GERRARD 5137-5138-5139.

TELEGRAMS: "ELLANGRICA RATH LONDON."

BRANCHES:

BELFAST: 49 Donegall Street	Telephone 27065
BIRMINGHAM: 16 John Bright Street	Telephone: Midland 3619
CARDIFF: 9 Park Lane	Telephone 7676
DUBLIN: 34 Lower Abbey Street	Telephone 45059
GLASGOW: 211 Hope Street	Telephone: Douglas 1305
LEEDS: 17 Wellington Street	Telephone 28259
MANCHESTER: Parsonage Chambers, 3 The Parsonage	Telephone: Blackfriars 8317
NEWCASTLE: 17 Fenkle Street	Telephone 23038





“VULCAN” TYPE D.L.

**HIGH INTENSITY 10-in. diam. REFLECTOR
ARC LAMP**

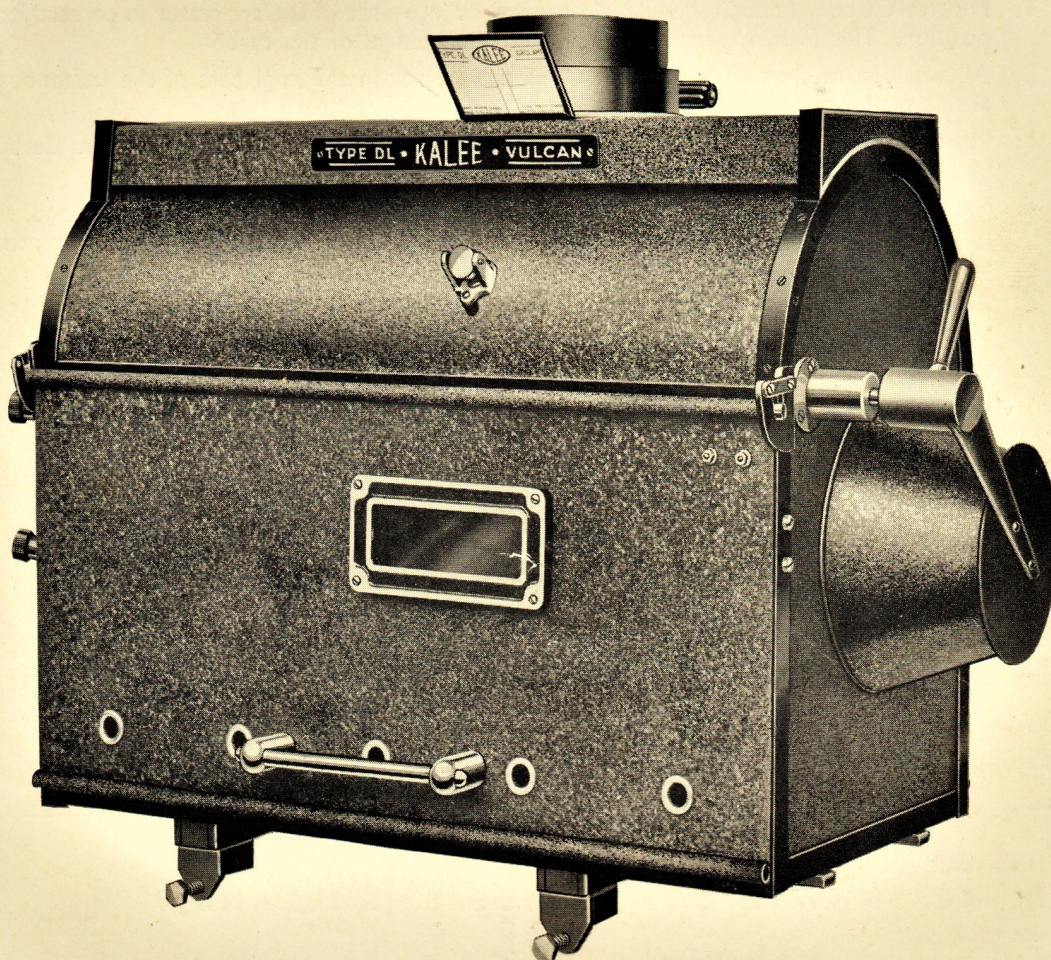

KALEE MEANS SERVICE





"VULCAN" TYPE D.L. HIGH INTENSITY REFLECTOR ARC LAMP

10-in. diam. ELLIPTICAL MIRROR

THE LAMP PRESENTS THE FOLLOWING FEATURES:

1. Positive Carbon is definitely guided, ensuring maintenance of the arc crater in correct focal position. This feature permits wide latitude in control of the carbon.
2. All working mechanism is located behind the mirror in the cool part of the Lamphouse, and is readily accessible for lubrication.
3. Positive and Negative Carbon Feeds may be operated simultaneously or separately. Carbon Holders are fitted with quick release to facilitate re-carboning.
4. The Energised Magnetic Arc Flame Control incorporated in this arc lamp allows the magnetic field strength to be adjusted automatically to suit individual current loadings, thus ensuring correct stabilisation and arc formation.
5. Alternative Gear Train, to suit burning ratios of alternative carbons, may be quickly inserted and is controlled by friction drive clutch.
6. Positive Carbon Feed is provided by means of coupling bar.
7. Potentiometer, Motor and Drive are integral in one unit—a simple matter to adapt to an existing Hand Feed Lamp.
8. Positive gravity type Carbon Holder will accommodate Carbons up to 10-mm. diameter. Negative Chuck type Carbon Holder is furnished with spring collets.
9. Rapid-action clip retaining 10-in. diameter Elliptical Mirror.
10. Vertical and horizontal movements to Negative Carbon are provided.

With Potentiometer-controlled Automatic Carbon Feed:—

PRICE: £65 0 0 CODE WORD: AUVUN

Without Automatic Carbon Feed, but adapted for Hand-feed to Carbons:—

PRICE: £50 0 0 CODE WORD: HAVUN

SOLE MAKERS:

A. KERSHAW & SON, LEEDS 8 (ENGLAND)

(Branch of Soho Limited)

SOLE DISTRIBUTORS:

KALEE LIMITED

HEAD OFFICE: NATIONAL HOUSE, 60-66 WARDOUR STREET, LONDON, W.1

TELEPHONE: GERRARD 5137-5138-5139

TELEGRAMS: "ELLANGRICA RATH LONDON."

BRANCHES:

BELFAST: 49 Donegall Street	Telephone 27065
BIRMINGHAM: 16 John Bright Street	Telephone: Midland 3619
CARDIFF: 9 Park Lane	Telephone 7676
DUBLIN: 34 Lower Abbey Street	Telephone 45059
GLASGOW: 211 Hope Street	Telephone: Douglas 1305
LEEDS: 17 Wellington Street	Telephone 28259
MANCHESTER: Parsonage Chambers, 3 The Parsonage	Telephone: Blackfriars 8317
NEWCASTLE: 17 Fenkle Street	Telephone 23038





"KERSHAW"

Series C Super

CINEMATOGRAPH PROJECTION LENSES

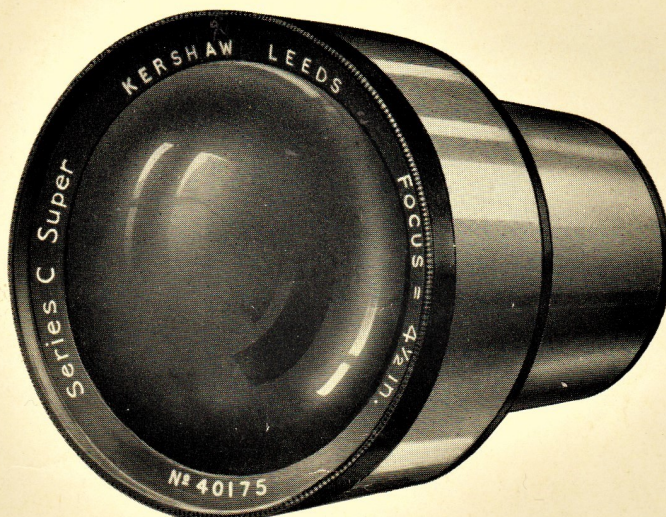

These excellent lenses are of recent and novel design, and represent a remarkable new development in projection optics.

The whole range of "Kershaw" **Series C Super Lenses** possess a constant F value. This means that the diameters of the lenses increase in direct proportion to the focal lengths, so that lenses of each focal length pass the same maximum amount of light to the screen, while the optical corrections ensure extremely fine, crisp definition and even illumination over the screen. The extended overall length of this series allows the back lens to approach close to the film and collect the maximum angle of light, and the large front component provides a clear path for the rays to reach the screen without being cut off. This range is very effective with the Model Twelve Projector, although naturally the increased diameters permit them to be used to advantage under any conditions.

The cells containing the lenses are black enamelled and robustly mounted in bright polished chromium-plated tube.

ENTIRELY BRITISH MADE.

Series "Super C."

Constant F value, F/2.2.

Focal Length in Inches	Price each	Code Word
$3\frac{1}{4}$ $3\frac{1}{2}$ $3\frac{3}{4}$ 4 $4\frac{1}{4}$ $4\frac{1}{2}$ $4\frac{3}{4}$ 5	£17 12 0	Cemes Cenit Cepow Cerax Cesev Cetiz Cevob Cewuc

Intermediate Focal Lengths, £1 2 0 extra.





"KERSHAW"

CINEMATOGRAPH PROJECTION LENSES



ENTIRELY BRITISH MADE.

Series "Super B."

Standard Size Mount, 1.68 inches diameter.

An entirely new optical system, constructed on original principles. The design allows the back element to collect the maximum amount of light and project it through the larger front element, giving even illumination on the screen. The definition throughout the whole series is of a high order.

Focal Length Inches	F Value	Price each	Code Word
$3\frac{1}{4}$	F 1.8	£11 11 0	Badek
$3\frac{1}{2}$	F 2.0		Bafil
$3\frac{3}{4}$	F 2.1		Bagom
4	F 2.2		Bicek
$4\frac{1}{4}$	F 2.4		Bidil
$4\frac{1}{2}$	F 2.5		Bifom
$4\frac{3}{4}$	F 2.7		Bigum
5	F 2.8		Bucil

Intermediate Focal Lengths, £1 2 0 extra.



“KERSHAW”

PROJECTION LENSES

Project a picture with perfectly clear definition over the full field, free from distortion and colour. No stops are used; therefore the highest illumination and efficiency is secured. Full advantage has been taken in designing these lenses to use the latest types of optical glasses, which are thoroughly transparent in respect of the actinic rays, hence the desired result of brilliancy.

CARE OF THE PROJECTION LENS

It is important to keep the lenses clean, and care should be taken not to handle them with greasy fingers.

A dirty lens will never project a good, clear picture.

Use a soft, clean piece of silk or old fine linen for cleaning, after first removing grit or dust by means of a camel-hair brush, otherwise scratches will appear in time, which impair the results and may mean the eventual repolishing of the lens. Grease can be removed with a little cotton wool moistened with alcohol.

SELECTION OF CORRECT FOCAL LENGTH

The focus of the lens governs the size of the projected picture on the screen, the longer the focus the smaller the size of the picture and *vice versa*.

The following tables of distances, etc., have been computed for Cinematograph Lenses in conjunction with a “talkie” mask of 0.825 in. wide. A further table has been computed for Lantern Lenses working with a slide mask of 3 in.

If, however, more accurate results are desired, these can be obtained from the formulæ below.

D = Distance in feet from lens to screen.

P = Width in feet of picture on screen.

M = Width in inches of mask.

F = Focus in inches of lens.

$$F = \frac{D \times M}{P} \quad P = \frac{D \times M}{F} \quad D = \frac{P \times F}{M}$$





PROJECTION TABLE FOR CINEMATOGRAPH LENSES

Showing width of Screen Picture at different distances with Lenses of different focal length.

“Talkie” Mask aperture 0.825 in. wide.

Distance Lens to Screen: Feet.	FOCUS OF LENS IN INCHES																				Width of Picture
	1 1/2 in. ft.	1 3/4 in. ft.	2 in. ft.	2 1/8 in. ft.	2 1/4 in. ft.	2 1/2 in. ft.	2 3/4 in. ft.	3 in. ft.	3 1/4 in. ft.	3 1/2 in. ft.	3 3/4 in. ft.	4 in. ft.	4 1/4 in. ft.	4 1/2 in. ft.	4 3/4 in. ft.	5 in. ft.	5 1/4 in. ft.	5 1/2 in. ft.	5 3/4 in. ft.	6 in. ft.	
10	5	6	4	8	4	1	3	4	1	3	9	3	6	3	3	3	3	3	3	3	—
12	6	10	5	10	5	2	5	6	4	1	3	9	3	6	3	3	3	3	3	3	—
15	8	3	7	0	6	3	7	4	6	6	0	5	6	5	0	4	5	4	1	4	—
20	11	0	9	5	8	3	7	4	6	6	0	5	6	5	0	4	5	4	1	4	—
25	13	9	11	9	10	3	9	2	8	3	7	6	10	6	4	5	3	3	3	3	0
30	16	6	14	0	12	4	11	0	9	9	9	0	9	9	0	4	5	4	1	4	3
35	19	3	16	6	14	5	12	10	11	4	10	4	10	4	9	4	7	4	5	4	1
40	22	0	18	10	16	6	14	8	13	0	12	11	0	10	8	3	7	8	7	4	3
45	24	9	21	2	18	6	14	9	13	0	12	11	0	9	5	6	6	3	6	5	4
50	27	6	23	7	20	7	18	4	16	6	15	9	11	8	8	7	4	7	0	6	8
55	30	3	25	9	22	7	20	2	18	6	15	0	13	9	8	8	3	7	10	7	5
60	33	0	28	0	24	8	22	0	19	6	16	3	10	7	7	10	8	3	7	10	10
65	—	30	30	6	26	9	23	1	21	1	19	6	17	10	16	5	10	8	3	7	6
70	—	33	0	28	10	25	8	22	8	21	0	19	3	17	8	16	10	11	4	10	8
75	—	—	—	30	11	27	6	24	4	22	6	20	4	18	10	17	8	16	10	11	3
80	—	—	—	33	0	29	4	26	0	24	6	22	6	20	18	10	17	8	16	10	11
85	—	—	—	—	31	2	27	9	25	8	22	6	23	4	21	11	8	16	10	11	3
90	—	—	—	—	33	0	29	6	27	0	24	9	24	8	21	19	10	18	16	10	11
95	—	—	—	—	—	31	3	28	6	26	1	24	9	24	8	21	19	10	18	16	10
100	—	—	—	—	—	33	0	30	6	27	0	26	12	24	9	24	8	21	19	10	11
110	—	—	—	—	—	—	33	0	30	6	27	0	26	12	24	9	24	8	21	19	10
120	—	—	—	—	—	—	—	33	0	30	6	27	0	26	12	24	9	24	8	21	19
130	—	—	—	—	—	—	—	—	33	0	30	6	27	0	26	12	24	9	24	8	21
140	—	—	—	—	—	—	—	—	—	33	0	30	6	27	0	26	12	24	9	24	8
150	—	—	—	—	—	—	—	—	—	—	33	0	30	6	27	0	26	12	24	9	24
160	—	—	—	—	—	—	—	—	—	—	—	33	0	30	6	27	0	26	12	24	8

The height of the picture is approximately $\frac{3}{4}$ the width.



"KERSHAW"

LANTERN OR TITLE PROJECTION LENSES

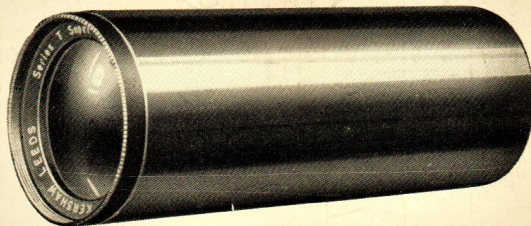

ENTIRELY BRITISH MADE.

Series "Super T."

Standard Size Mounts, 2.07 inches diameter.

A new series of Lenses embodying an extremely efficient optical system. Designed with a short back focus, enabling the lens to focus nearer to the slide, thereby collecting a considerable increase of light.

8 in. to 30 in., equivalent focus **£2 9s. 6d.** each
(Advancing by 2 in.)

Intermediate focal lengths **5s. 6d.** extra

CODE WORD: SUTIL

When Coding add focus in inches to Code Word.





PROJECTION TABLE FOR LANTERN LENSES

Showing Size of Screen Picture at different distances with Lenses of different focal length.

Mask Size, 3 inches.

Distance Lens to Screen Feet	FOCUS OF LENS IN INCHES														Size of Pict- ure
	4 in. ft. in.	6 in. ft. in.	8 in. ft. in.	10 in. ft. in.	12 in. ft. in.	14 in. ft. in.	16 in. ft. in.	18 in. ft. in.	20 in. ft. in.	22 in. ft. in.	24 in. ft. in.	26 in. ft. in.	28 in. ft. in.		
10	7 6	5 0	3 9	3 0	2 6	2 2	1 10	1 8	1 6	1 4	1 3	1 2	1 1	}	
12	9 0	6 0	4 6	3 7	3 0	2 7	2 3	2 0	1 9	1 7	1 6	1 4	1 3		
15	11 3	7 6	5 8	4 6	3 9	3 3	2 10	2 6	2 3	2 0	1 10	1 9	1 8		
20	15 0	10 0	7 6	6 0	5 0	4 3	3 9	3 4	3 0	2 9	2 6	2 4	2 2		
25	18 9	12 6	9 4	7 6	6 3	5 4	4 8	4 2	3 9	3 5	3 1	2 11	2 8		
30	22 6	15 0	11 3	9 0	7 6	6 5	5 7	5 0	4 6	4 1	3 9	3 6	3 3		
35	26 3	17 6	13 1	10 6	8 9	7 6	6 7	5 10	5 3	4 9	4 4	4 0	3 9		
40	30 0	20 0	15 0	12 0	10 0	8 6	7 6	6 8	6 0	5 4	5 0	4 7	4 3		
45	33 9	22 6	16 10	13 6	11 3	9 8	8 5	7 6	6 9	6 1	5 7	5 2	4 10		
50	37 6	25 0	18 9	15 0	12 6	10 9	9 4	8 4	7 6	6 10	6 3	5 9	5 4		
60	45 0	30 0	22 6	18 0	15 0	12 11	11 3	10 0	9 0	8 2	7 6	6 11	6 5	}	
70	52 6	35 0	26 3	21 0	17 6	15 1	13 1	11 8	10 6	9 6	8 9	8 1	7 6		
80	60 0	40 0	30 0	24 0	20 0	17 1	15 0	13 4	12 0	10 11	10 0	9 3	8 7		
90	67 6	45 0	33 9	27 0	22 6	19 5	16 10	15 0	13 6	12 3	11 3	10 5	9 8		
100	75 0	50 0	37 6	30 0	25 0	21 7	18 9	16 8	15 0	13 8	12 6	11 6	10 8		

In selecting a Lantern Lens, its Focus should be approximately $4\frac{1}{2}$ times that of the Cinematograph Lens.

SOLE MAKERS: **A. KERSHAW & SON, LEEDS 8 (ENGLAND)** (Branch of Soho Limited)

SOLE DISTRIBUTORS:

KALEE LIMITED

HEAD OFFICE: NATIONAL HOUSE, 60-66 WARDOUR STREET, LONDON, W.1

TELEPHONE: GERRARD 5137-5138-5139.

TELEGRAMS: "ELLANGRICA RATH LONDON."

BRANCHES:

BELFAST: 49 Donegall Street	Telephone 27065
BIRMINGHAM: 16 John Bright Street	Telephone: Midland 3619
CARDIFF: 9 Park Lane	Telephone: 7676
DUBLIN: 34 Lower Abbey Street	Telephone: 45059
GLASGOW: 211 Hope Street	Telephone: Douglas 1305
LEEDS: 17 Wellington Street	Telephone: 28259
MANCHESTER: Parsonage Chambers, 3 The Parsonage	Telephone: Blackfriars 8317
NEWCASTLE: 17 Fenkle Street	Telephone: 23038





"KALEE"

FILM REWINDERS

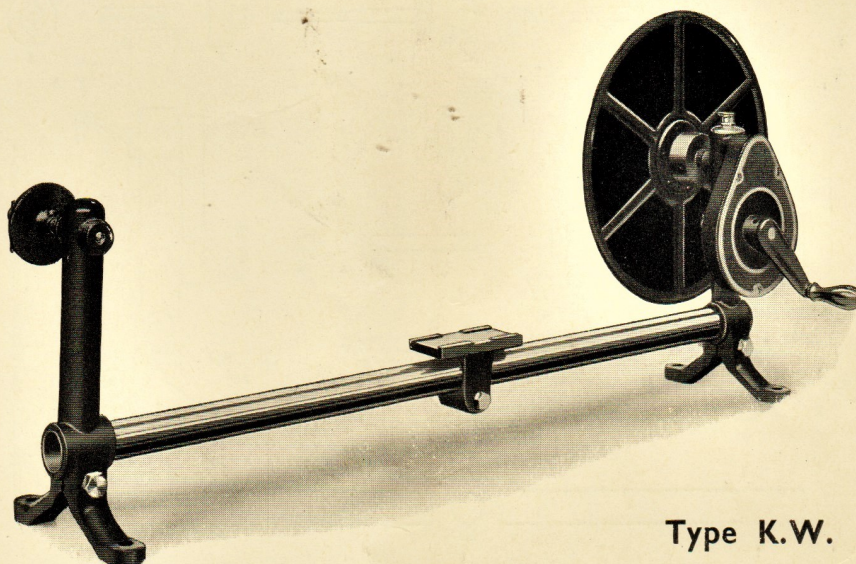

Type K.W.

Type K.W. Rewinder is a new model of heavy construction, built to withstand hard and continuous service.

The Standards are made of cast-iron of novel design, accurately machined and coupled together by a strong steel tube 39 in. long. A cast-iron block machined out to film width is supplied as a simple fixture for scraping and jointing film. The Gears are machine cut and enclosed by a suitable cover. A 12-in. pressed-steel disc is provided for loose film rewinding. Black stove enamel finish to castings, steel tube chromium plated.

PRICE, complete with scraping block **£4 4 0**

CODE WORD: KWINE

PRICE, without scraping block **£3 18 0**

CODE WORD: KWILT





"KALEE" FILM REWINDERS

SPARE PARTS FOR K.W. REWINDER

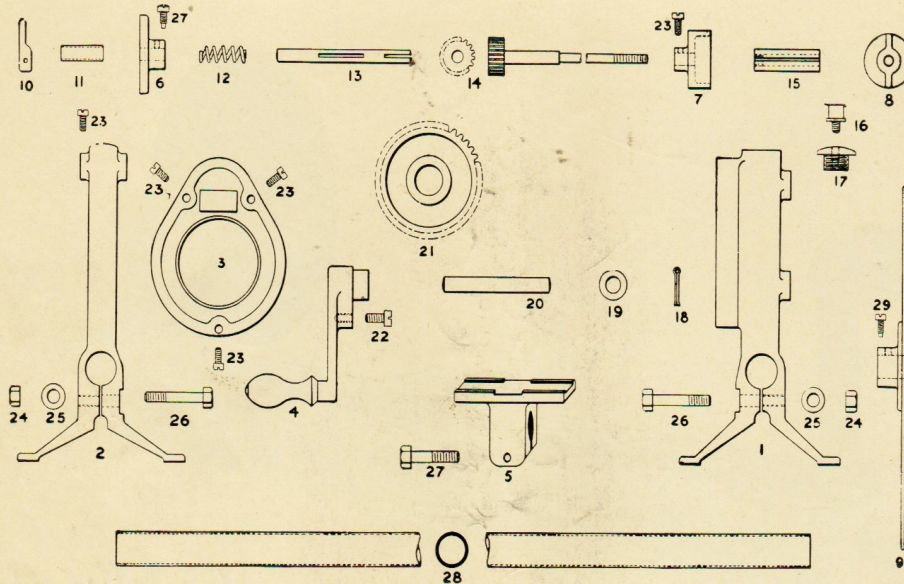

No.	DESCRIPTION	s.	d.	No.	DESCRIPTION	s.	d.
1	Gear Standard	each	14 6	16	Lubricator	each	1 0
2	Plain Standard	"	9 9	17	Cap for Gear Standard	"	2 9
3	Gear Cover	"	2 9	18	Split Pin for No. 20 Spindle	"	4
4	Handle and Crank	"	7 3	19	Washer for No. 20 Spindle	"	4
5	Joining Table	"	6 0	20	Main Gear Spindle	"	2 3
6	Boss for Plain Standard	"	1 9	21	Main Gear Wheel	"	7 3
7	Collar for Gear Standard	"	2 0	22	Screw for No. 4	"	6
8	Wing Nut	"	1 3	23	Screws for Covers Nos. 2, 3 and 7	"	6
9	Steel Disc with Boss	"	6 0	24	Nuts for No. 26	"	4
10	Retaining Snek for No. 13	"	9	25	Washers for No. 25	"	4
11	Distance Tube	"	9	26	Bolt, Clamping Steel Tube for Nos. 1 and 2	"	9
12	Spring for No. 6 Boss	"	9	27	Bolt for No. 5	"	9
13	Spindle for Plain Standard	"	1 9	27a	Screw for No. 6	"	9
14	Spindle and Pinion for Gear Standard	"	9 0	28	Stay Tube	"	7 3
15	Brass Bush for No. 9	"	1 9	29	Screw for No. 9	"	9

SOLE MAKERS:

A. KERSHAW & SON, LEEDS 8 (ENGLAND)

(Branch of Soho Limited)

SOLE DISTRIBUTORS:

KALEE LIMITED

HEAD OFFICE: NATIONAL HOUSE, 60-66 WARDOUR STREET, LONDON, W.1

TELEPHONE: GERRARD 5137-5138-5139.

TELEGRAMS: "ELLANGRICA RATH LONDON."

BRANCHES:

BELFAST: 49 Donegall Street	Telephone 27065
BIRMINGHAM: 16 John Bright Street	Telephone: Midland 3619
CARDIFF: 9 Park Lane	Telephone 7676
DUBLIN: 34 Lower Abbey Street	Telephone 45059
GLASGOW: 211 Hope Street	Telephone: Douglas 1305
LEEDS: 17 Wellington Street	Telephone 28259
MANCHESTER: Parsonage Chambers, 3 The Parsonage	Telephone: Blackfriars 8317
NEWCASTLE: 17 Fenkle Street	Telephone 23038





"KALEE" STEEL SPOOLS

ALUMINIUM CENTRE

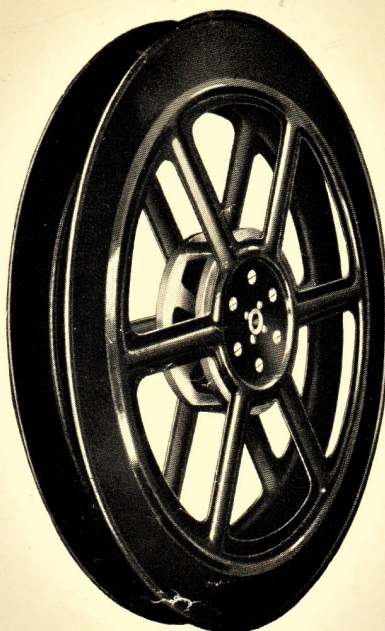

This Spool has been designed to meet the demand for an All-Metal Spool of better quality than the standard type with hardwood centre.

The cheeks are made from stampings in heavy-gauge cold rolled steel, suitably ribbed to give strength and rigidity.

A cast-aluminium centre piece, machined all over is used to carry the cheeks, which are securely held by machine screws.

Two sizes are made, $14\frac{3}{4}$ -in. diameter and $17\frac{1}{2}$ -in. diameter, with 5-in. diameter centre, to fit $\frac{3}{8}$ -in. diameter spindles.

The cheeks are finished bright black stoved enamel.

PRICE, $14\frac{3}{4}$ -in. diameter:

12s. each.

CODE WORD:

KEBIC

PRICE, $17\frac{1}{2}$ -in. diameter:

18s. each.

CODE WORD:

KECAP





SOLE MAKERS:

A. KERSHAW & SON, LEEDS 8 (ENGLAND)

(Branch of Soho Limited)

SOLE DISTRIBUTORS:

KALEE LIMITED

HEAD OFFICE: NATIONAL HOUSE, 60-66 WARDOUR STREET, LONDON, W.1

TELEPHONE: GERRARD 5137-5138-5139.

TELEGRAMS: "ELLANGRICA RATH LONDON."

BRANCHES:

BELFAST: 49 Donegall Street	Telephone 27065
BIRMINGHAM: 16 John Bright Street	Telephone: Midland 3619
CARDIFF: 9 Park Lane	Telephone 7676
DUBLIN: 34 Lower Abbey Street	Telephone 45059
GLASGOW: 211 Hope Street	Telephone: Douglas 1305
LEEDS: 17 Wellington Street	Telephone 28259
MANCHESTER: Parsonage Chambers, 3 The Parsonage	Telephone: Blackfriars 8317
NEWCASTLE: 17 Fenkle Street	Telephone 23038

